

Indian Peafowl

(Pavo cristatus)

The Indian peafowl is the national bird of India, and can be found mainly in India, Pakistan, Sri Lanka, and other areas of south Asia. The male, known as the peacock, has large, brightly-colored feathers, which he displays to attract females (peahens) during courtship in spring. Peacock feathers are a beautiful iridescent blue, making them popular for use in artwork. Peafowl are also considered very useful birds to keep as they eat poisonous insects and snakes.

Assembly Instructions

- 1) Carefully cut out the parts.
- 2) Make mountain folds and valley folds along the dotted lines, as indicated by the directions.
- 3) Assemble the parts in the order shown by the numbers on the glue tabs. (Read the assembly instruction for more information.)
- 4) Attach the parts in order. (Read the assembly instruction for more information.)
- 5) Your Paper craft model is finished.









Tools

Scissors, glue (We recommend a strong adhesive such as woodwork glue.)

Caution

Glue, scissors and other tools may be dangerous to young children so be sure to keep them out of the reach of young children.

Notation Key

	—————	Scissors line
	—————	Cut in line
		Cut out
	—————	Glue up to this line
	-----	Mountain fold
	-----	Valley fold
	●	Glue spot

Assemble A①.

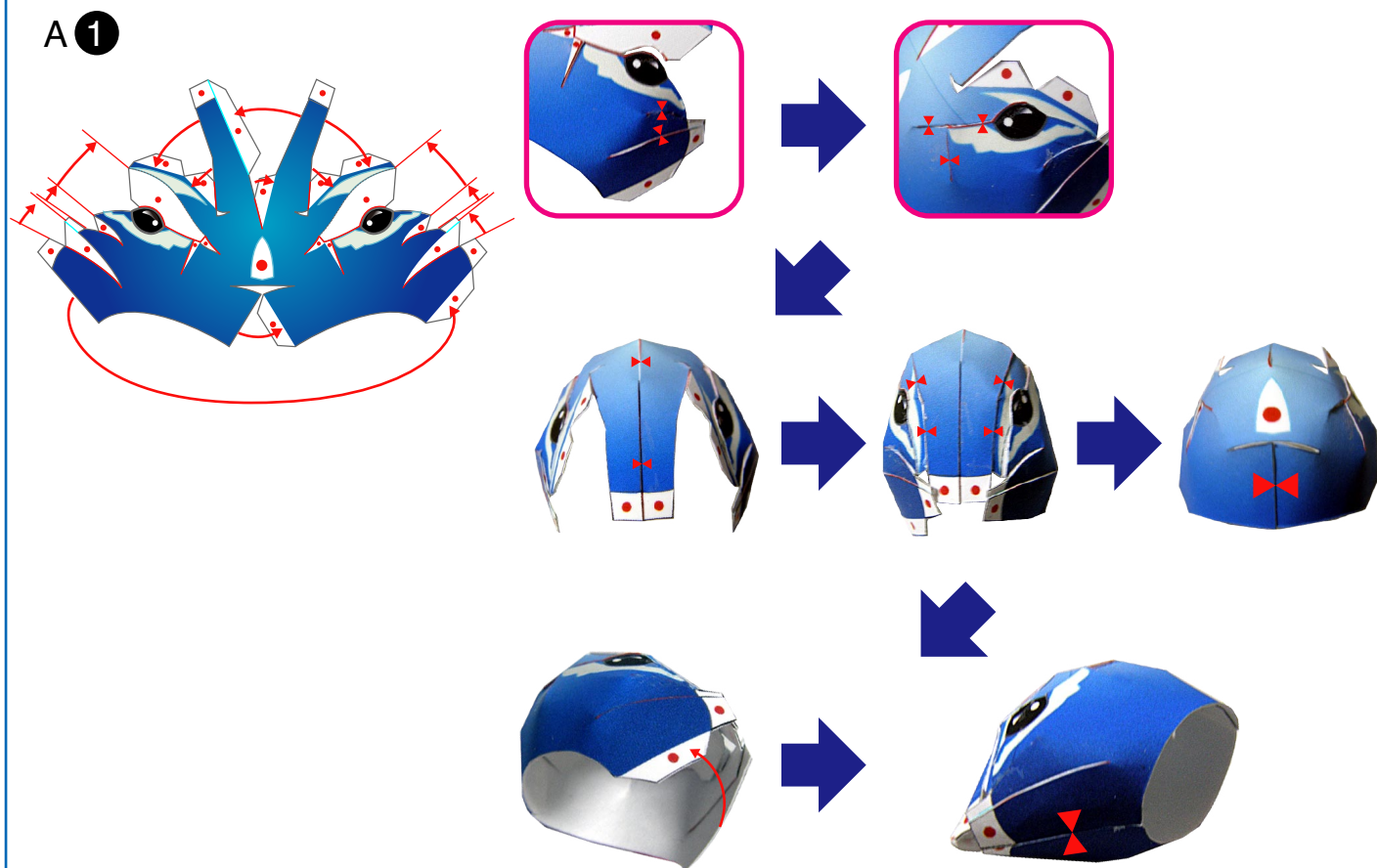

Assemble A②, A③, A④ and A⑤, attach them to A①.

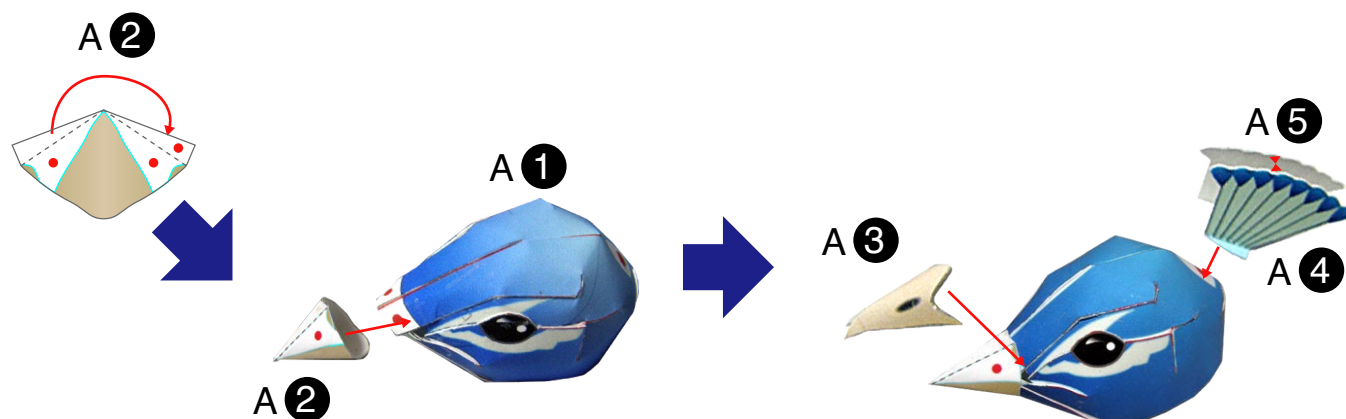

Assemble A⑥, A⑦, A⑧, A⑨ and A⑩, attach them to A⑪.

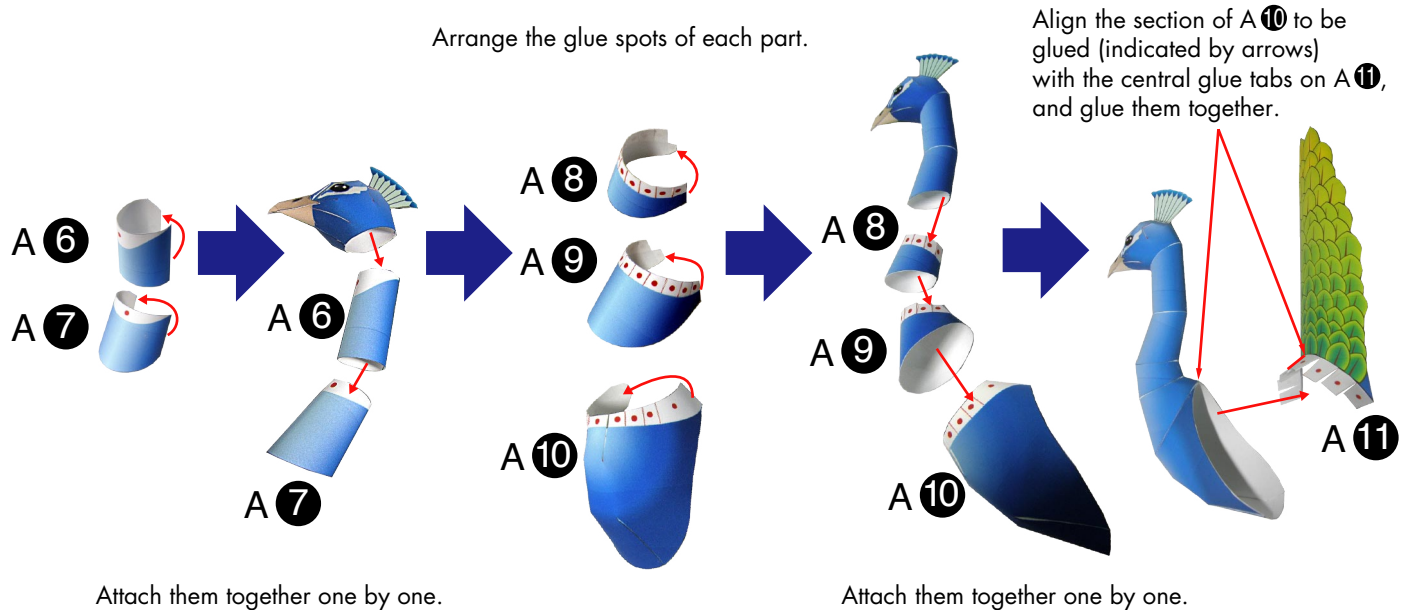

Assemble B① and B②, and make the internal frame.

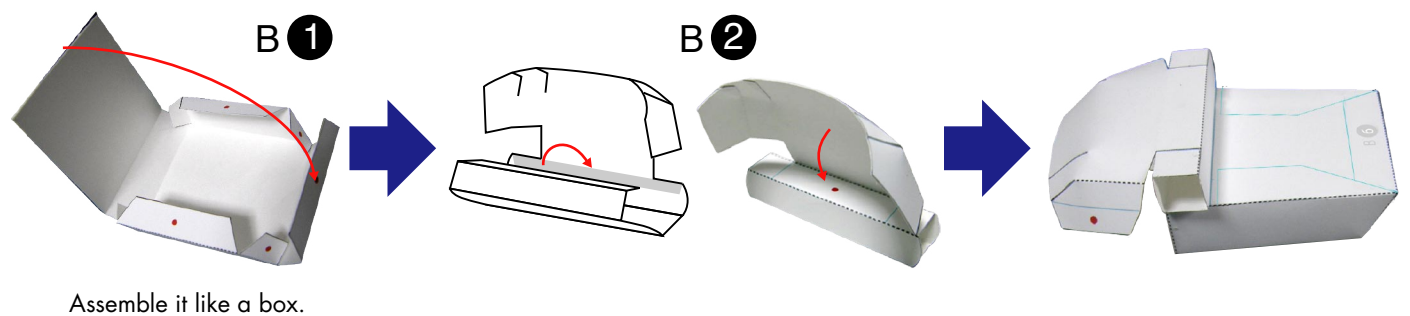

Assemble B③, B④ and B⑤.

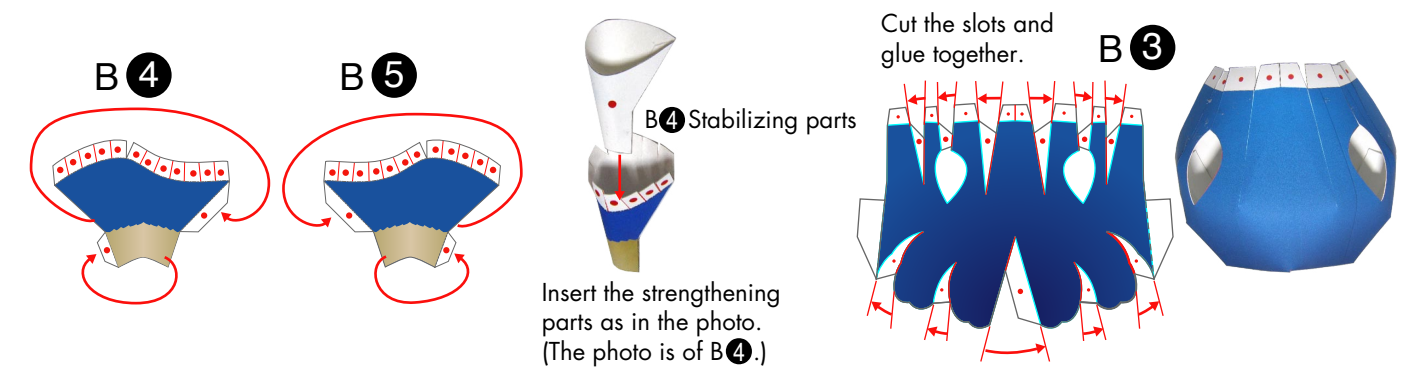

Attach B ④ and B ⑤ to B ③ from behind.

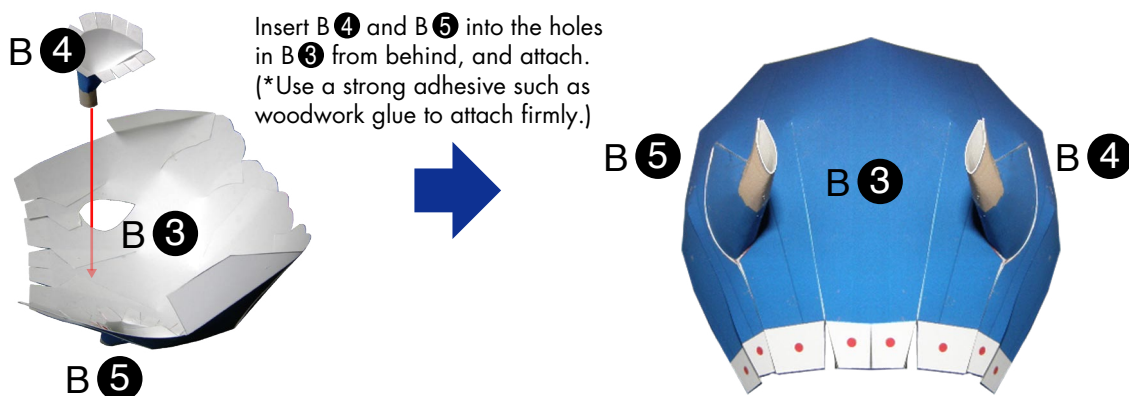

Assemble B ⑥, B ⑦, and B ⑧, and complete the body.

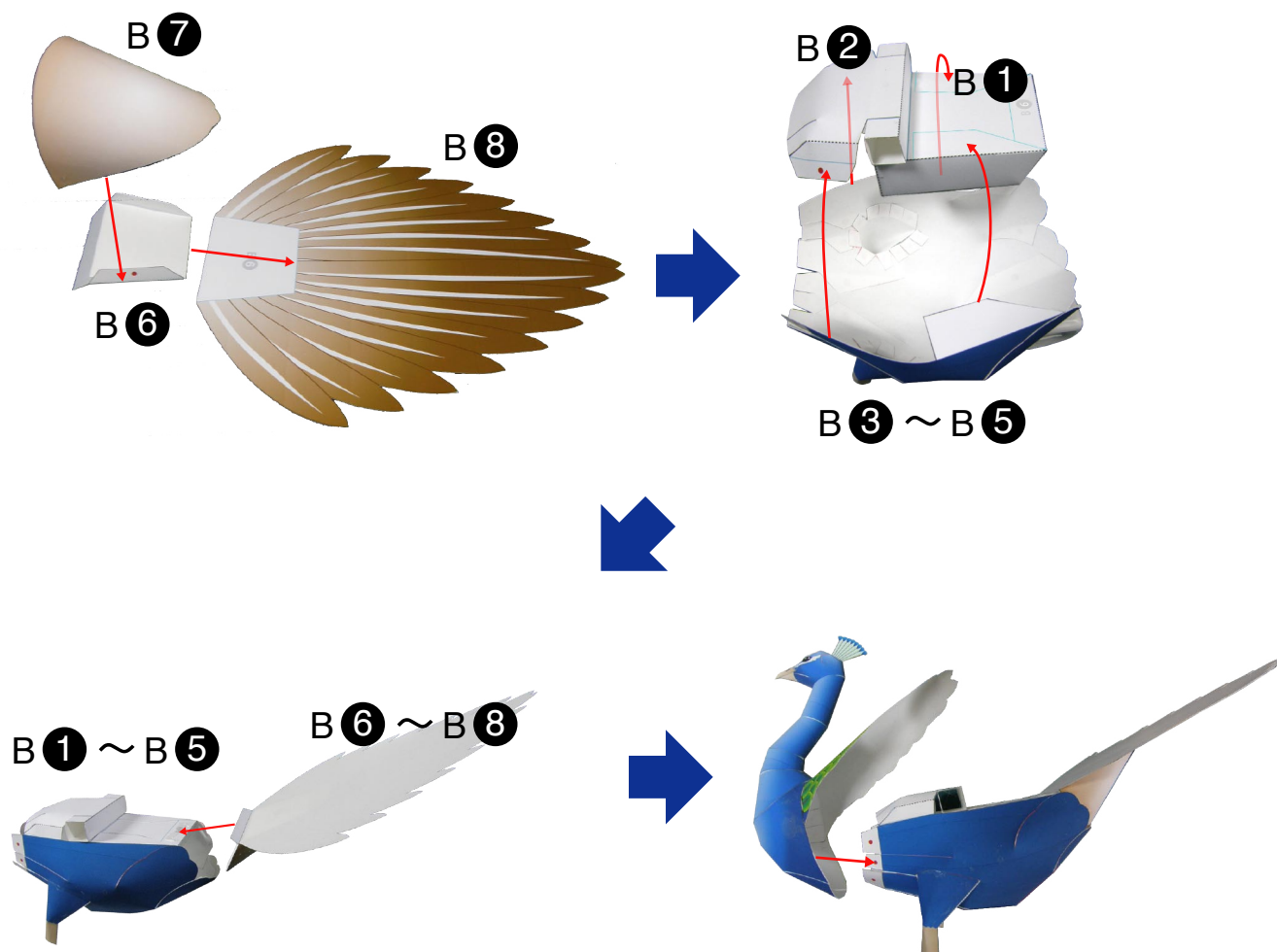

Assemble B 11, B 12, B 13 and B 14, insert the leg cores and attach the legs to the body.

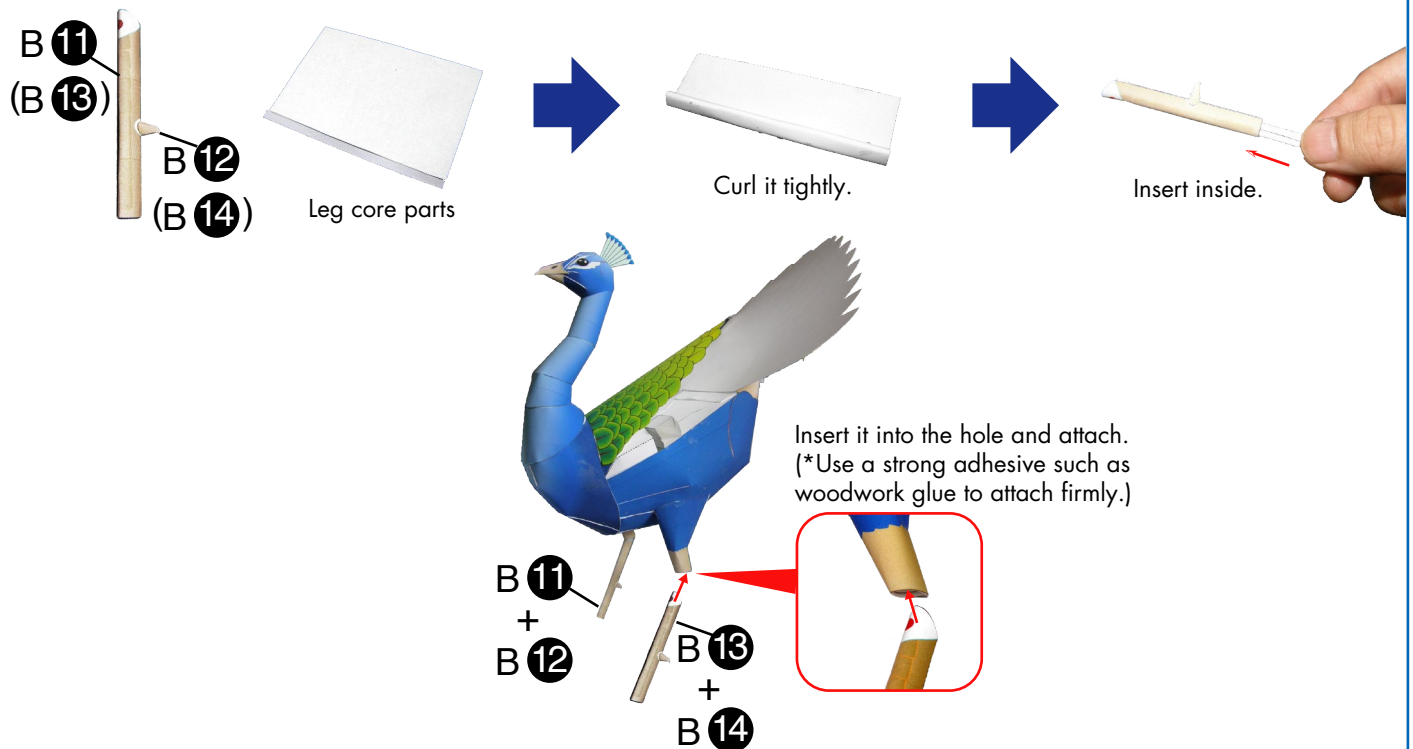

Assemble B 15 ~B 20 and B 21 ~B 26, make the feet, assemble B 27 and B 28, and make the stand.

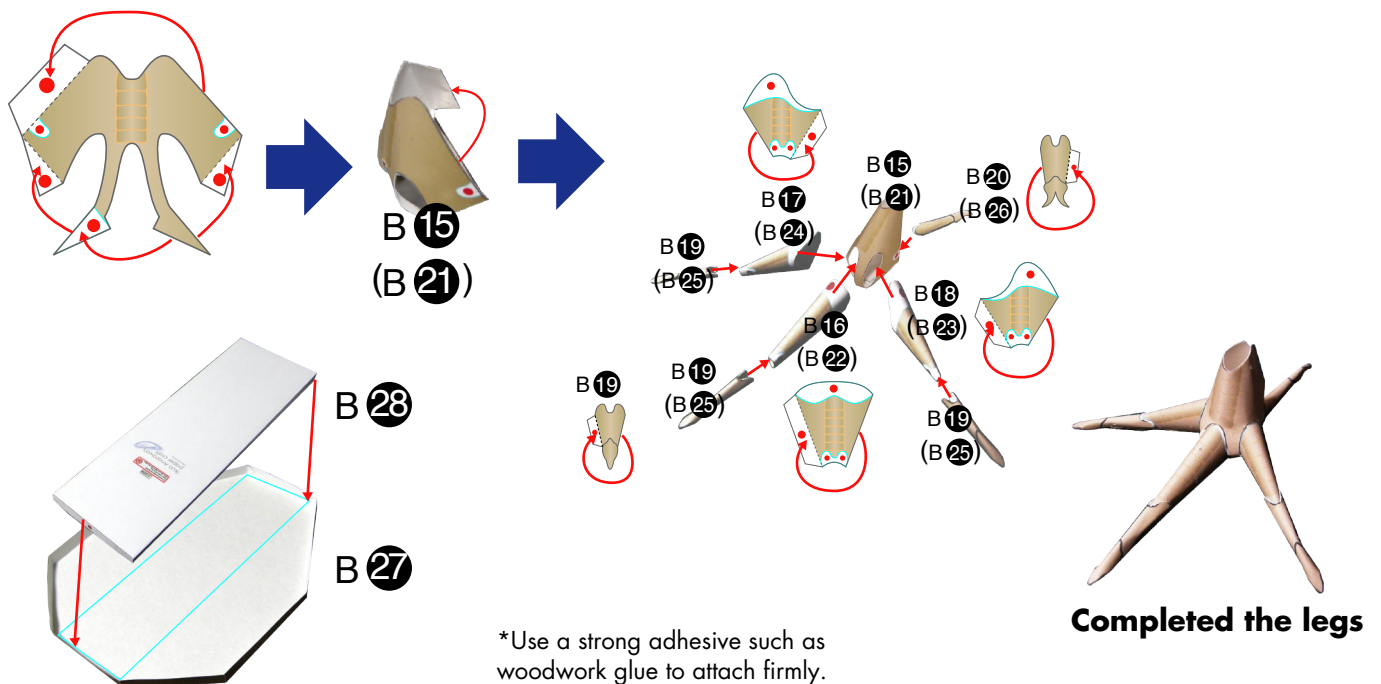

Glue C1 ~C10 together, and D1 ~ D10 together, and make both sides of the tail feathers.

Attach C1 to C10.

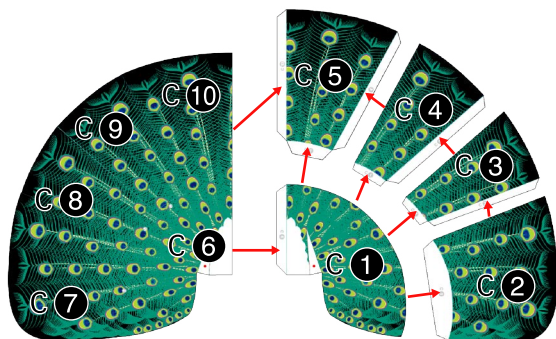

Front of tail feathers

It will be curved in this direction.

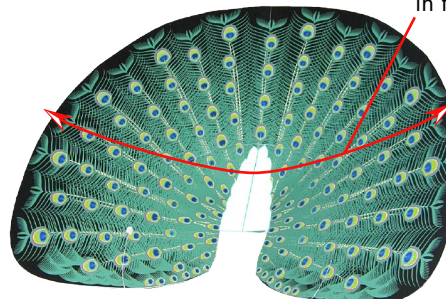

Attach D1 to D10.

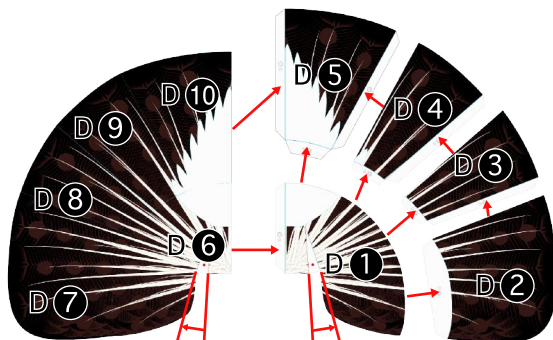

Back of tail feathers

It will be curved in this direction.

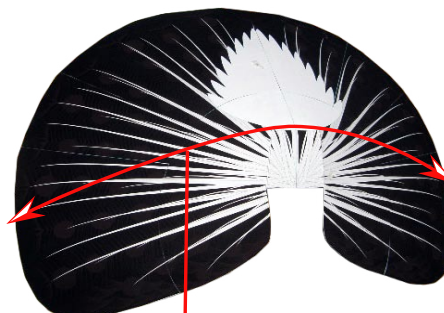

Attach the front of tail feathers and the back of tail feathers.

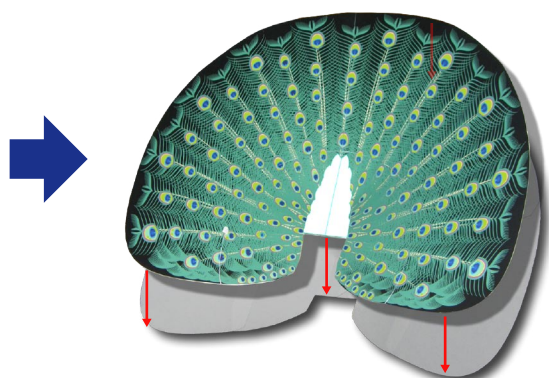

After gluing them together, cut away the excess black areas around the edge, using the red line as a guide.

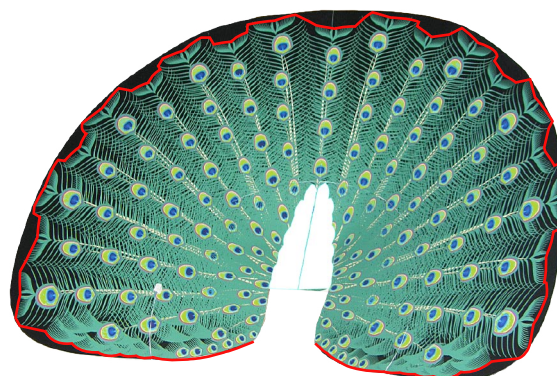

Make B⑨ and B⑩ (the wings), attach all the parts together and complete your indian peafowl.

Attach B⑨ and B⑩ to the internal frame B②, aligning it with the guide.

Align A⑪ with the guide on B⑧, and attach the tail feathers.

